

# Project Newsletter

## Cundy Street Quarter

14<sup>th</sup> of November 2022 Issue No 12

Dear Neighbours,

I hope you are all well.

Please see below the works that have been carried out in October and the planned works to be undertaken in November.



- **Walden House Green Wall** – We have completed the installation of the green hoarding located within Walden House courtyard



- **New UKPN Temporary sub-station** – works located adjacent to our site boundary near the Coleshill Flats are progressing well. So far we have completed the trench excavation for the new UK Power Networks (UKPN) supply and constructed the electricity sub-station base. Over the upcoming 3 weeks we will progress with the construction of the sub-station walls, roof slab and door installation which will all occur near the site boundary. We anticipate completing the works, week commencing 28<sup>th</sup> November and apologies for any inconvenience caused to date.
- **Preparation for new gas connection to Walden House** - we will be temporarily excavating a new trench within the Walden House courtyard for a new gas supply. This will commence 29<sup>th</sup> of

November for a duration of 9 days. Pedestrian access will be maintained at all times. Please see below plan highlighting area of works. The gas connection works will take place at a later date which is yet to be agreed with Cadent gas. We will communicate this, once known, closer to the time.

Disruption to access to Walden House will be minimal during this time and pedestrian access will be maintained.

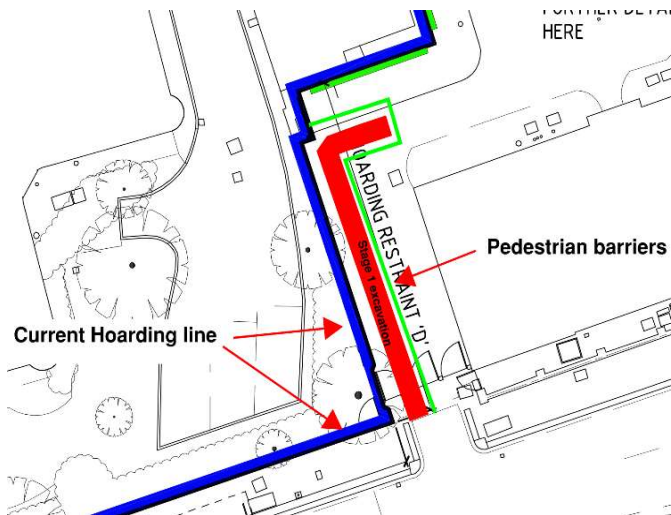

Phase 1.

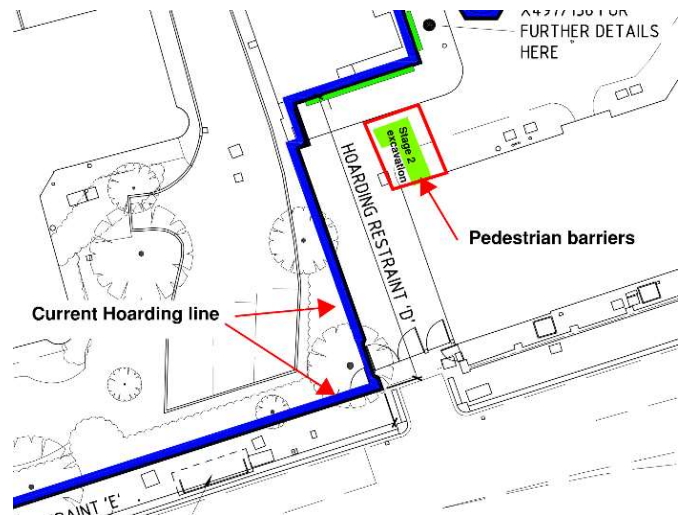

Phase 2.

- **Installation of scaffold to existing buildings on CSQ Project** – Starting from the first week of December, we will commence the erection of the scaffolding screens to Stack House, Laxford House, Lochmore House and Kylestrome House. The monaflex sheeting will be added to the outside of these buildings prior to demolition works which provides noise and dust mitigation.

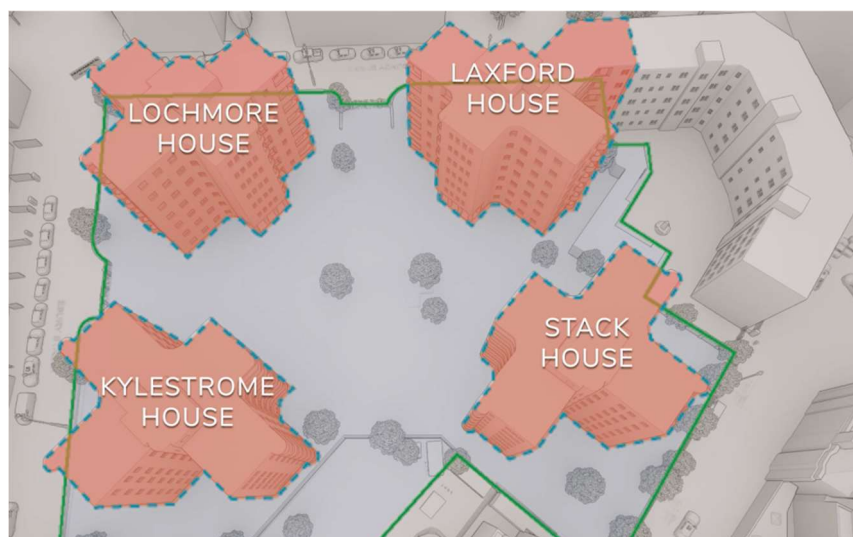

We would like to thank all of you that attended "Meet the Contractor" event which was held in St Barnabas Church on 25<sup>th</sup> of October. It was a real pleasure to meet you all and talk through our works and the project. If you were unable to attend the event you can view the information that was presented on the Cundy Street project website: <https://cundystreetquarter.co.uk/demolition-and-construction/>

Below are some of the questions that were raised during “Meet the Contractor” event that we would like to update you on:

### 1. Pedestrian entry/exit location off Ebury St and welfare orientation

We took on board the feedback received from the “Meet the Contractor” event and are currently looking at alternative locations further away from the Coleshill buildings. We will aim to update you with our updated welfare strategy and any changes to the entry/exit locations within the next newsletter.

### 2. Dust and Noise mitigation controls:

We have now installed noise and dust monitors on site which monitor noise and air quality 24/7. Escaping noise and dust caused by the demolition works will be minimised by fully wrapping the scaffolding with protective sheeting called monaflex. Dust will also be suppressed using water mist.

In addition, our environmental monitors will generate real time email alerts when trigger levels are reached, emails are immediately sent to our team for action and review. If the trigger levels are reached due to ongoing works on site, we will stop the activity responsible for the exceedance and we will undertake further measures and controls required to ensure compliance.

### 3. Lorry routes:

One of our first activities following the commencement of the demolition will be the forming of our new vehicle access off Pimlico Road. Until then, temporary access for our site setup will be off Cundy St from the existing access point. This will likely be for the first two weeks of works and we will be keeping vehicle movements to a minimum. We will also have two large machinery deliveries in our setup phase that due to their size will need to be delivered off Ebury St. We will issue separate details specifically for these two special deliveries closer to the time.



**Fig. 1 Cundy St Temporary Access**

## Main Works

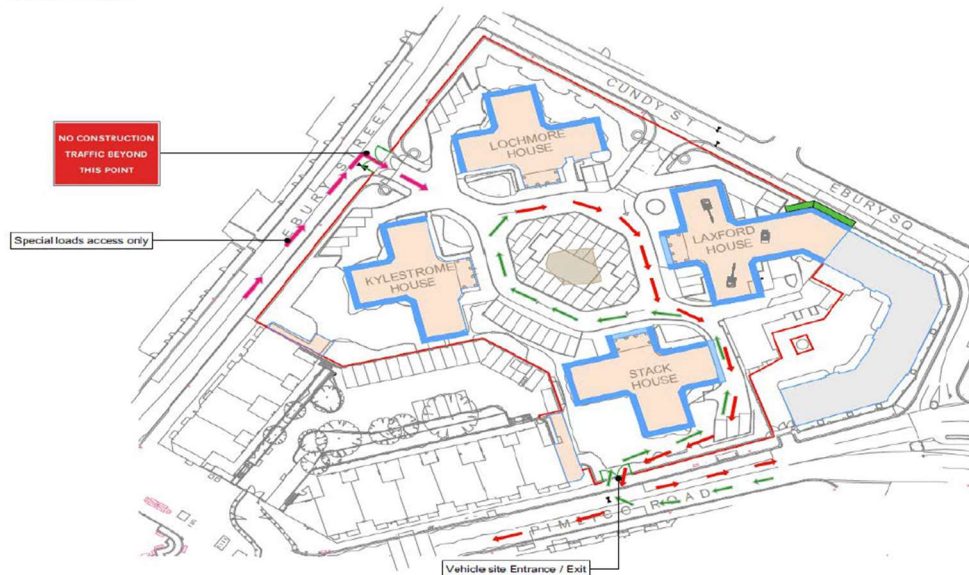

**Fig. 2 Pimlico St Access once access gate is constructed**

Please do not forget about our Cundy Street Quarter Community Hub, located on **Pimlico Road No 20a which is open Tuesdays and Thursdays between 9am and 12pm for all** residents and the local community that would like to find out more information regarding upcoming works, or just for a friendly chat and a cup of tea or coffee.

Kindest Regards

**Gabriel Stetco**

Project Manager, John F Hunt,

Tel 07773 628 380

Email [Gabriel.Stetco@johnfhunt.co.uk](mailto:Gabriel.Stetco@johnfhunt.co.uk)

## Site Contact Details

If you have any queries or suggestions, please contact your site team:

Gabriel Stetco  
Project Manager  
07773 628380  
[gabriel.stetco@johnfhunt.co.uk](mailto:gabriel.stetco@johnfhunt.co.uk)



Michael Frisby  
Contracts Manager  
07734 866602  
[Michael.frisby@johnfhunt.co.uk](mailto:Michael.frisby@johnfhunt.co.uk)



### Considerate Constructors Scheme

This site is registered with the Considerate Constructors Scheme. As part of this initiative, we contact our neighbours, provide regular updates on the project, and ensure a clean and tidy site boundary

For further information, please visit  
[www.ccscheme.org.uk](http://www.ccscheme.org.uk)



### NFDC

We are a corporate member of the National Federation of Demolition Contractors which ensures that expertise is maintained and reinforced.

For further information, please visit  
[www.demolition-nfdc.com](http://www.demolition-nfdc.com)