

GENERAL NOTES

GENERAL NOTES:
Existing drawings are for reference only - not for approval.

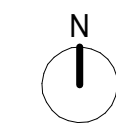

Planning Boundary

Only 9 of the lower ground floor residential units are subject to this application: refer to drawing P10.002 for details

Due to the scale and complexity of the land owned by the applicant close to or adjoining the application site, it is not possible to include a blue line to indicate its ownership on a property by property basis. Should information regarding the applicant's ownership of adjoining land be considered of material importance this can be provided during the determination period.

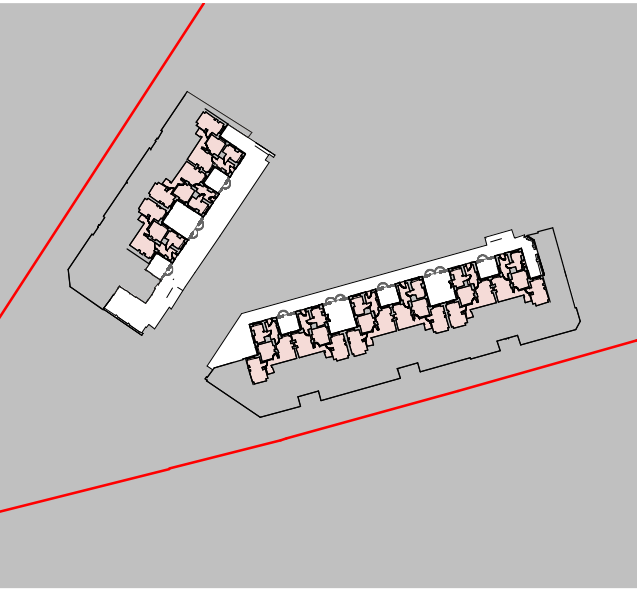

Cudny Street Quarter Lower Ground Floor Plan

15/05/20 Issued for Planning

PLANNING

rev	date	author / check	comments
DSDHA 357 Kennington Lane London SE11 5QY T 020 7703 3555 F 020 7703 3890 E info@dsha.co.uk W www.dsha.co.uk			
project Cudny Street Quarter London, SW1			
drawing title Location Plan			
drawn	size	date	scale
MPe	A1	15/05/20	1 : 1250
drawing number			revision
288 _P10.001			-
REPORT DISCREPANCIES DO NOT SCALE FROM THIS DRAWING COPYRIGHT DSDHA		USE LATEST REVISION CHECK DIMENSIONS ON SITE	

